

**Key**

- ① Root Resistant Decothane Top Coat applied in strict accordance with Sika Liquid Plastics Project Specification
- ② Root Resistant Decothane Base Coat applied at correct coverage rate for surface conditions, embedded with Sika Reemat Premium GFM
- ③ Sika Liquid Plastics Preparatory Layer bonded in strict accordance with Sika Liquid Plastics Specification
- ④ Existing substrate prepared in strict accordance with Sika Liquid Plastics Project Specification
- ⑤ Sika Liquid Plastics Eco Inverted Roof Board [board size 1250 x 600mm]
- ⑥ Sika MinFX Separation Layer [used to minimise the rainwater cooling effect on the insulation boards thus maintaining the thermal properties]
- ⑦ AquaDrain<sup>PLUS</sup> proprietary drainage system with integral Filtration [top] and Protection [bottom]
- ⑧ SikaGrow<sup>PLUS</sup> growing medium
- ⑨ Pre-grown vegetation blanket, plug plants or cuttings/seeds
- ⑩ Suitable paving slabs laid on typical adjustable pedestal supports
- ⑪ Optional Sika EdgeGuard<sup>PLUS</sup> used to demarcate zones and prevent migration of loose components

Vegetation Options	SikaGrow <sup>PLUS</sup> Thickness	Gross Wet Weights
Sika Sedum Prime	50 - 70mm	100kg/m <sup>2</sup>
Sika Sedum Plug	70 - 90mm	100 - 125kg/m <sup>2</sup>
Sika Sedum Seed	70 - 90mm	100 - 125kg/m <sup>2</sup>
Sika Meadow Prime	120mm	170kg/m <sup>2</sup>
Sika Meadow Plug	100 - 250mm	125 - 340kg/m <sup>2</sup>
Sika Meadow Seed	100 - 250mm	125 - 340kg/m <sup>2</sup>

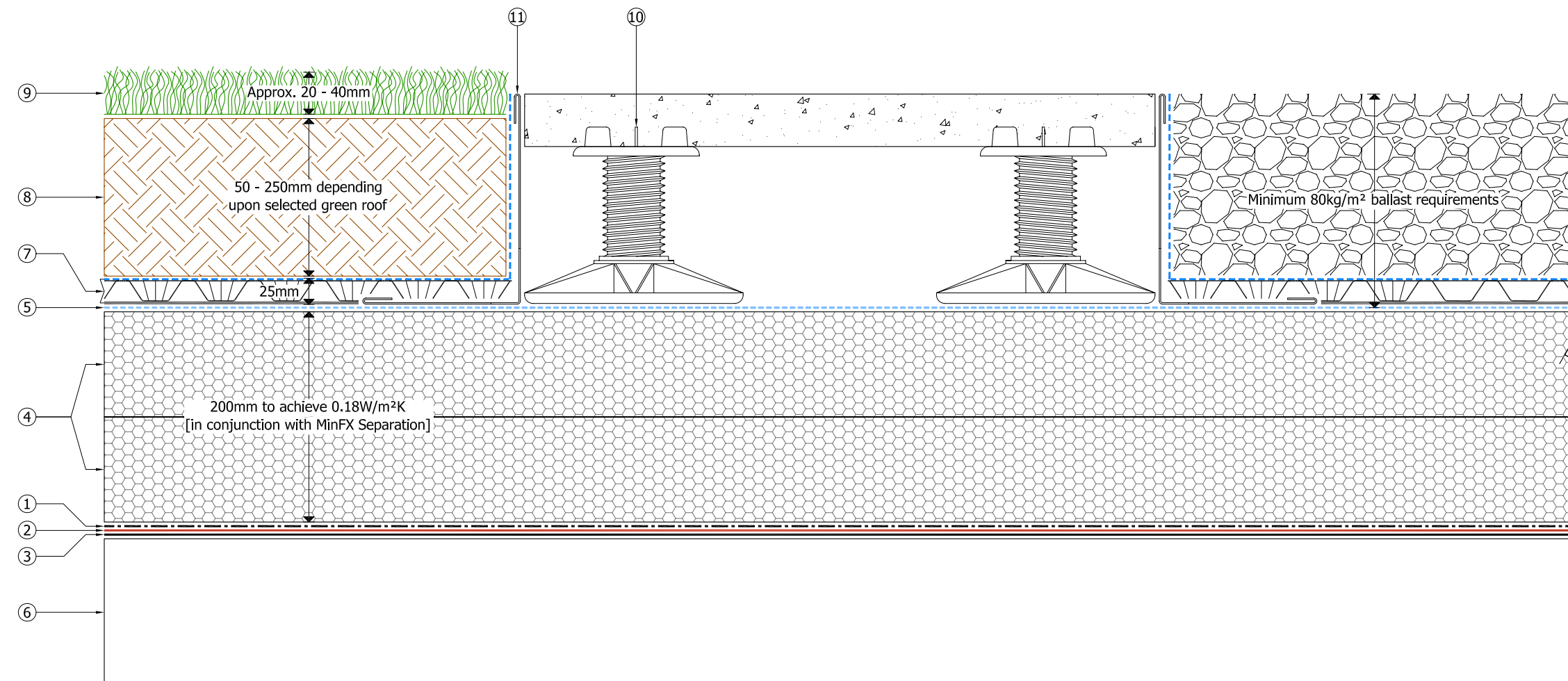

**Sika Liquid Plastics**  
 Sika House  
 Miller Street  
 Preston  
 Lancashire PR1 1EA  
 Telephone: 01772 259781  
 Email: [technical.customer.services@uk.sika.com](mailto:technical.customer.services@uk.sika.com)  
[www.liquidplastics.co.uk](http://www.liquidplastics.co.uk)

This drawing is solely intended to illustrate the correct application of Sika Liquid Plastics products and systems. It must be read in conjunction with the appropriate specification and current issue of relevant Product Data Sheets. All elements bearing reference to structural and/or thermal design are shown indicatively and should not be used in whole or in part for any aspect of project design without consulting the relevant authorities.

For refurbishment projects, all aspects of the existing roof are deemed to be fully compliant with BS 6229:2003 [Code of Practice for Flat Roofs with Continuously Supported Coverings] or improved upon for instances where these standards are not met.

Site-specific details not covered by our standard range can be obtained by providing relevant information to the email address shown.

Project No:	Revision:
DWG No:	

Project:

Drawing Title:  
 Green Roof installation over an  
 Inverted Roof showing interface with  
 paving on typical pedestal supports

Scale: NTS @ A3      Drawn:

Date:

